

LFS-880TAB Side Flexing Plastic Chain

Plate Materials: POM-LF
Pin Material: Stainless Steel
Dry Temp Range: -50°F to 200°F
Wet Temp Range: -45°F to 185°F

DIMENSIONS	INCH	MM
P	1.5	38.1
R	15.748	400.0
H	.787	20.0
T	.157	4.0
F	.300	7.6
E	.280	7.1
M	2.406	61.1
N	1.689	42.9
S	.630	16.0
G	.453	11.5
RD	1.575	40.0
GC (Straight)	1.811	46.0
GC (Curve)	1.740	44.2

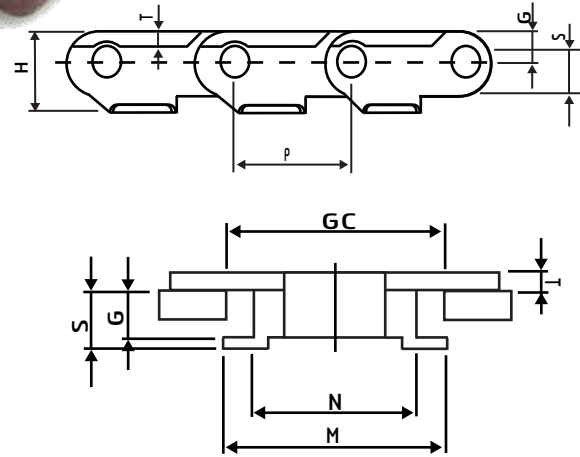
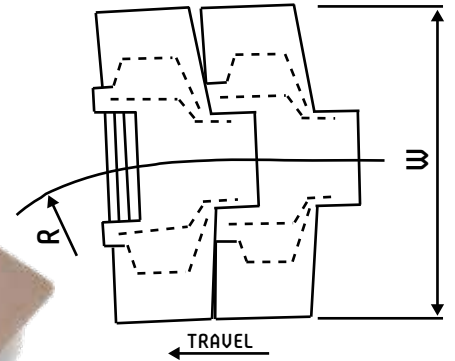

Sprockets and Idler Wheels Available in a Variety of Tooth Counts and Bore Sizes.

CHARACTERISTICS	WIDTH W		WORKING LOAD		RADIUS		Rev Radius		WEIGHT
	MM	INCH	N(70lbs)	Lbs(70F)	MM	INCH	MM	INCH	lbs/ft
LFS-880TAB K325	82.5	3.25	2100	472	457	18.00	40	1.575	.632
LFS-880TAB K450	114.5	4.50	2100	472	500	19.69	40	1.575	.723
LFS-880TAB K600	152.4	6.00	2100	472	560	22.05	40	1.575	.887
LFS-880TAB K750	190.5	7.50	2100	472	610	24.00	40	1.575	.907

Standard shipping lengths = 80 pitches = 10 ft. = 3.048 M

Conveying Innovation to Industry