

SF-1100AB-N

Perforated Flat Top

.6" Pitch

Direct Replacement for:
Intralox 1100
Perforated Flat Top, 5/32" Round Hole

*Non-headed Rods

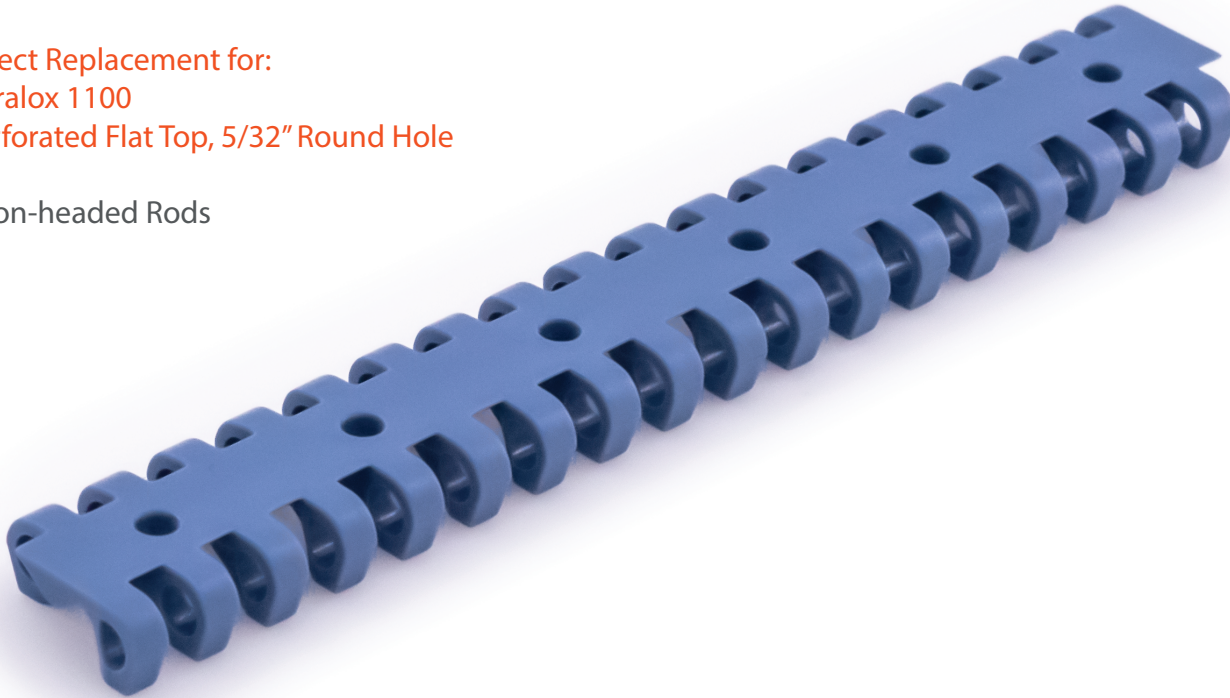

Pitch	Thickness	Min Width	Rod	Open Area	Flights	Side Guards
.6"	.334"	3"	.18"	3%	Yes	No
15.2mm	8.7mm	76mm	4.6mm			

Belt Material	Standard Rod Material	Belt Strength		Temperature Fahrenheit		Belt Weight Lb/Ft ²	Colors
		Straight Lb/Ft	Curved Lb/Ft	Min	Max		
PP	PP	1038	-	33°	230°	1.07	W, G, B
PE	PE	988	-	-76°	140°	1.23	N, B
Acetal	PE	1109	-	-50°	180°	1.54	W, B
Nylon	PE	1052	-	33°	356°	1.43	BR

BW = Belt Width, W-WHITE, B-BLUE, DB-DARK BLUE, RB-ROYAL BLUE, N-NATURAL, G-GRAY, BK-BLACK, BR-BROWN

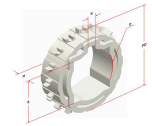

# of Teeth	PD	Bore Size
12	2.28"	1"R,
16	3.07"	1"R, 1.5"S
24	4.65"	1"R, 1.5"S
32	6.22"	1"R, 1.5"S
18-2R	3.48"	1.5"S
20-2R	3.45"	1.5"S
26-2R	5.06"	1.5"S
32-2R	6.18"	1.5"S

Special Order Sprockets Available

Belt Standard Alterations	+/- 1"
Flight Standard Indent	+/- 2"



SAFARI Belting Systems, Inc.

Conveying Innovation to Industry